

3-49-9

SE-SE

#6662

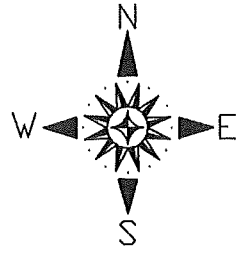

BEARINGS ARE GRID BASED
WCCS - BAYFIELD COUNTY
WITH THE EAST LINE OF THE
SOUTHEAST 1/4, SECTION 3
MEASURED TO BEAR S0°00'21"W

LEGAL DESCRIPTION:

THE SOUTH 166' OF THE NORTH 1162' OF THE SOUTHEAST 1/4 OF THE SOUTHEAST 1/4, SECTION 3, TOWNSHIP 49 NORTH, RANGE 9 WEST, TOWN OF ORIENTA, BAYFIELD COUNTY, WISCONSIN; MORE PARTICULARLY DESCRIBED AS FOLLOWS:

PARCEL 1

COMMENCING AT THE SOUTHEAST CORNER OF SAID SECTION; THENCE N0°00'21"E ALONG THE EAST LINE OF THE SOUTHEAST 1/4 OF SAID SECTION A DISTANCE OF 92.08' TO THE POINT OF BEGINNING; THENCE N88°37'29"W A DISTANCE OF 1304.57'; THENCE N0°01'27"W ALONG THE WEST LINE OF THE SOUTHEAST 1/4 OF THE SOUTHEAST 1/4 OF SAID SECTION A DISTANCE OF 166.00'; THENCE S88°37'29"E A DISTANCE OF 1304.66' TO THE EAST LINE OF THE SOUTHEAST 1/4 OF THE SOUTHEAST 1/4 OF SAID SECTION; THENCE S0°00'21"W ALONG THE EAST LINE OF THE SOUTHEAST 1/4 OF THE SOUTHEAST 1/4 OF SAID SECTION A DISTANCE OF 166.00' TO THE POINT OF BEGINNING.

THE ABOVE DESCRIBED PARCEL OF LAND CONTAINS 216,503 SQUARE FEET OR 4.97 ACRES INCLUDING THE RIGHT OF WAY OF SEVERSON ROAD.

PLAT OF SURVEY

THE SOUTH 166' OF THE NORTH 1162' OF THE SOUTHEAST 1/4 OF SOUTHEAST 1/4, SECTION 3, TOWNSHIP 49 NORTH, RANGE 9 WEST, TOWN OF ORIENTA, BAYFIELD COUNTY, WISCONSIN

CENTER 1/8 SE CORNER
SEC.3 T.49N. R.9W.
FD. 1 1/2" IRON PIPE

EAST 1/8 CORNER
SEC.3 T.49N. R.9W.
FD. 2" IRON PIPE

EAST 1/8 CORNER
SEC.3 T.49N. R.9W.
FD. 1 1/2" IRON PIPE

N 00°01'27" W 1,279.89'

S 88°37'15" E 1,305.27'

R.O.W. 33'

F.O.W. 33'

S 00°00'21" W 2,508.16'
(N 00°00'12" E) (2,508.18')

SEVERSON ROAD

R.O.W. 33'

F.O.W. 33'

P.O.B.

SOUTHEAST CORNER
SEC.3 T.49N. R.9W.
FD. RAILROAD RAIL

S 88°37'29" E

1,304.66'

1,270.66 TO R.O.W.

PARCEL 1

216,503 SQ. FT.
4.97 ACRES

N 88°37'29" W

1,271.57 TO R.O.W.

1,304.57'

E. ORIENTA FALLS ROAD

N 89°45'30" W 1,304.15'

SURVEYOR'S CERTIFICATE

I, Patrick A McKuen, Wisconsin Professional Land Surveyor S-2992, Do hereby certify that this map was made at the direction of Bayfield County. The information shown on this map is correct and accurate to the best of my knowledge and belief. This map also meets the minimum standard requirements for surveys under Act 17 Wisconsin Administrative Code.

Patrick A. McKuen
Bayfield County Surveyor
WI P.L.S. S-2992

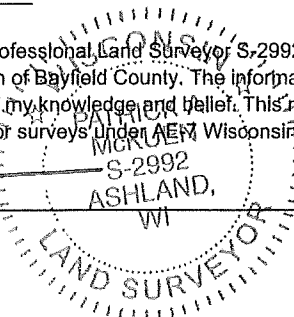

9-30-2020

Date

Legend

- - SET 1" O.D. X 18" IRON PIPE
- - FOUND MONUMENT AS NOTED
- () - PREVIOUSLY RECORDED INFORMATION

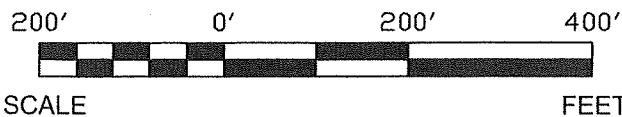

BAYFIELD COUNTY LAND RECORDS
117 East 5th Street
Washburn, WI 54891
(715) 737-6156
www.bayfieldcounty.org

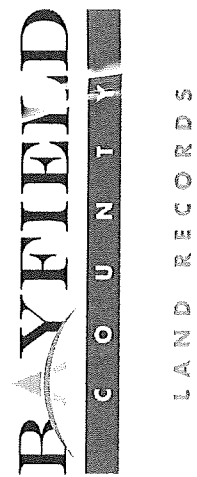

Drawn by: RAT
Approved by: PAM
Date Approved: 9/14/20
Filed with: Bayfield County
Field work completed: 8/20/20
Project No. 490903002

BAYFIELD COUNTY

THE SOUTH 166' OF THE NORTH 1162' OF THE SE 1/4 OF THE SE 1/4, SECTION 3, T.49N., R.9W., TOWN OF ORIENTA, BAYFIELD COUNTY, WI